

SEC. 17 TN.3S RG.11E

SEE MAP 201-06

201-09

NOTE: THE SOUTH LINE OF NANTUCKET LODE M.S. 2829 AND THE NORTH LINE OF CABANATUNE M.S. 3752 DO NOT AGREE IN DISTANCE OR BEARING

THE ORIGINAL PLAT OF THIS SUBDIVISION IS ON FILE WITH THE PINAL COUNTY RECORDERS OFFICE, FOR COMPLETE INFORMATION OF PLAT AND CC&R'S CALL (520) 868-7100.

SEE MAP 201-03

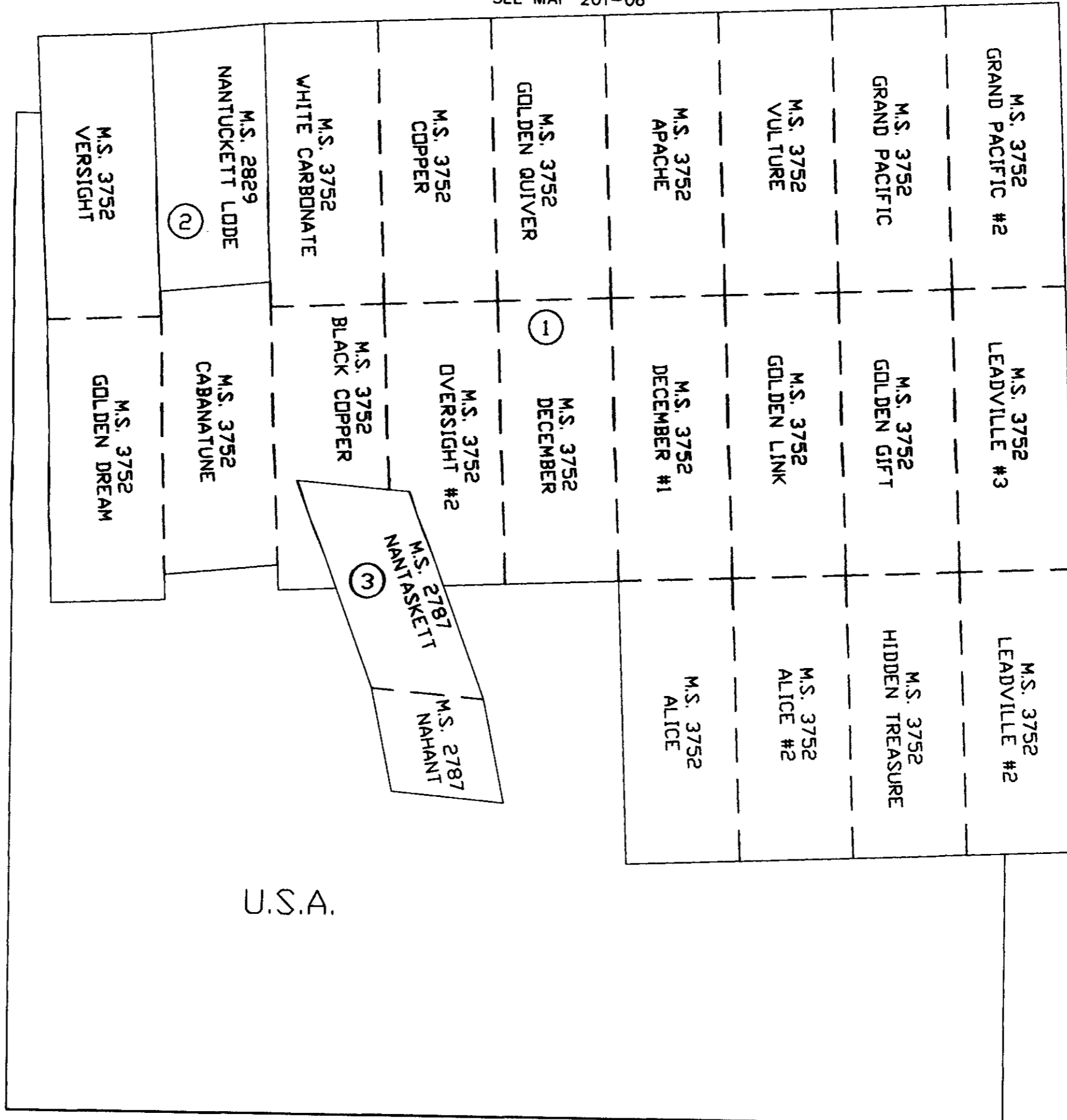

U.S.A.

SEE MAP 201-10

SEE MAP 201-03

AREA CODE
0000

SPECIAL DISTRICTS
00000
00000

THIS MAP IS FOR TAX PURPOSES ONLY.
THIS OFFICE WILL NOT ASSUME LIABILITY FOR REPRESENTATION, MEASUREMENTS OR ACREAGE.

VICINITY MAP

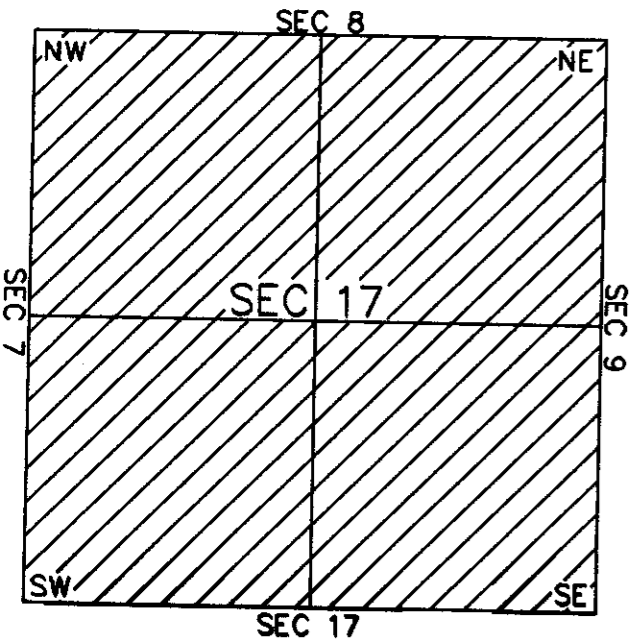

SCALE: 1" = 600'

08-17-2001