

SEC. 31 TN.5S RG.8E

SEE MAP 209-28

209-29

AREA CODE
2114

SPECIAL DISTRICTS
12662
16608

THIS MAP IS FOR TAX PURPOSES ONLY
THIS OFFICE WILL NOT ASSUME LIABILITY FOR
REPRESENTATION, MEASUREMENTS OR ACREAGE.

SEE BOOK 509

N MACRAE RD

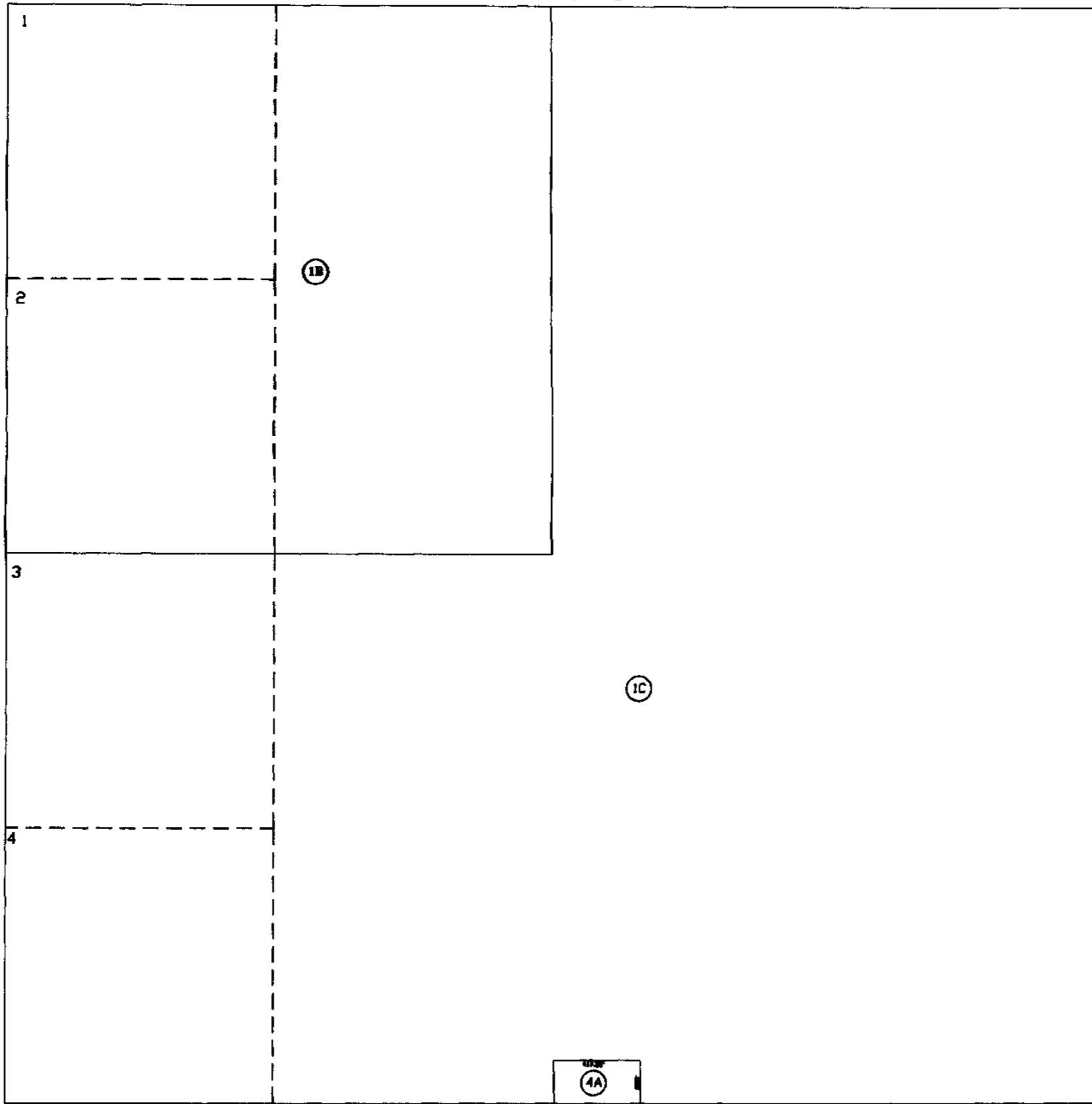

N SKOUSEN RD

SEE MAP 209-30

THE ORIGINAL PLAT OF THIS SUBDIVISION IS
ON FILE WITH THE PINAL COUNTY RECORDERS
OFFICE, FOR COMPLETE INFORMATION OF PLAT
AND CC&R's CALL (520) 868-7100

VICINITY MAP

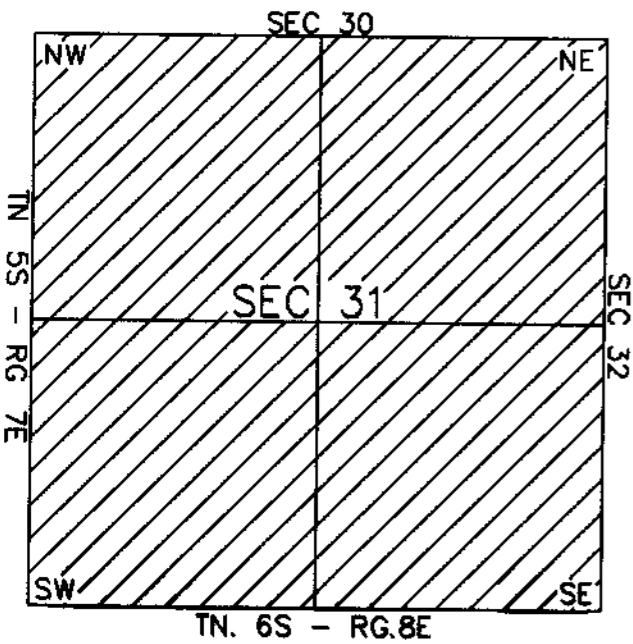

W BARTLETT RD

SEE BOOK 401



SCALE 1" = 600'

09-03-2001