

SEE MAP 210-25

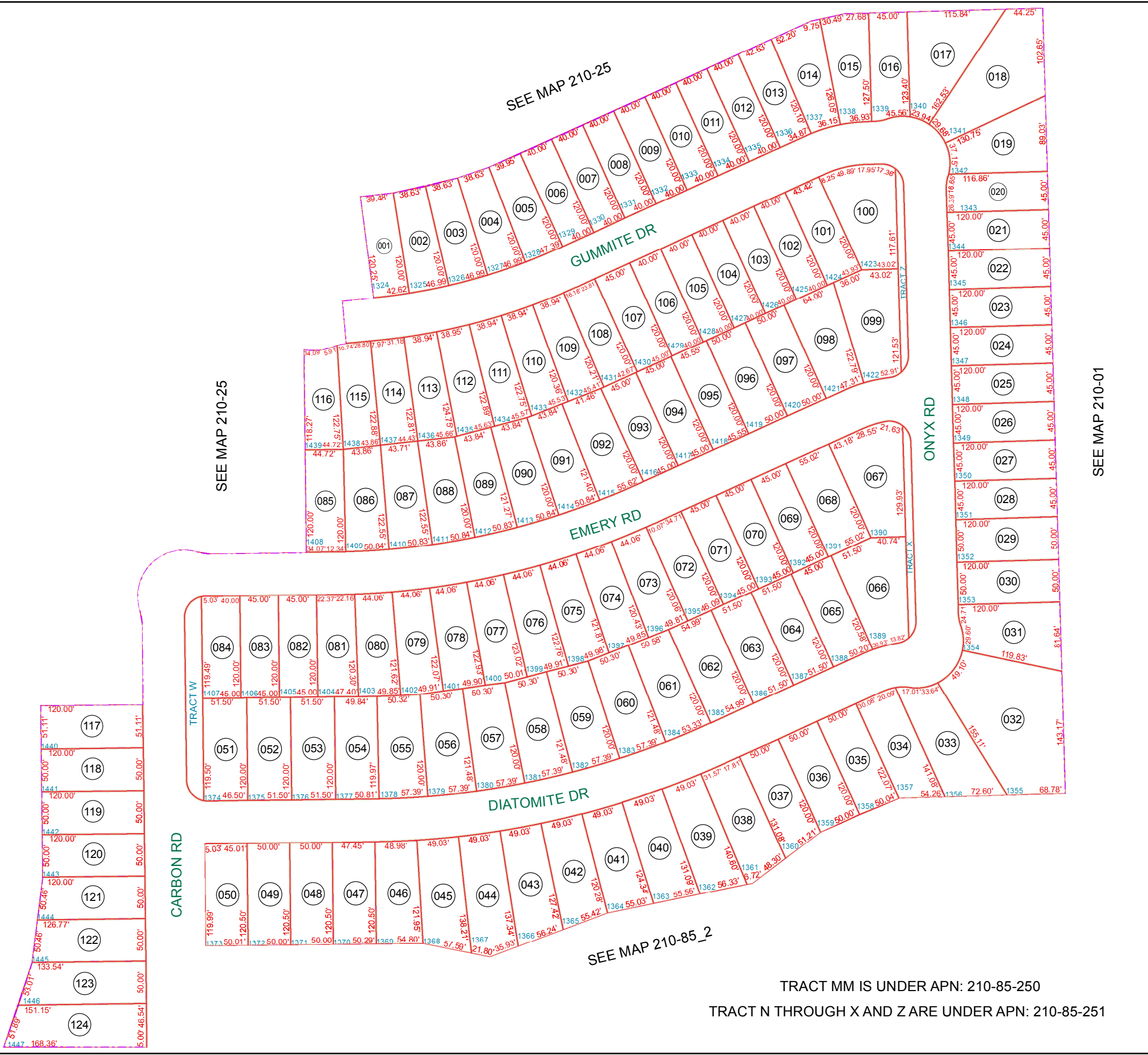

SEE MAP 210-25

SEE MAP 210-01

SEE MAP 210-25

SEE MAP 210-85\_2

TRACT MM IS UNDER APN: 210-85-250

TRACT N THROUGH X AND Z ARE UNDER APN: 210-85-251

BOOK - MAP

# 210-85\_1

SE SEC. 27 T.03S. R.08E.  
THE VILLAGE AT COPPER BASIN  
UNIT 5C-2: 2017-019533

LOCATION MAPS  
R.E.

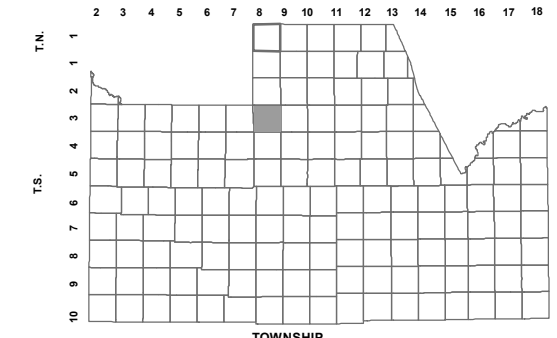

HASH KNIFE DRAW RD		SCHNEPP RD		ATTAWAY RD	
6	5	4	3	2	1
SKYLINE DR		GALZARD RD		SIERRA VISTARD	
7	8	9	10	11	12
ROBERTS RD		BELLA VISTARD		QUAIL RUN LN	
18	17	16	15	14	13
CARY RD		JUDD RD		ARIZONA FARMS RD	
19	20	21	22	23	24
HUNTPARK		MAGMA RD		ATTAWAY RD	
30	29	28	26	25	
31	32	33	34	35	36
SECTION					

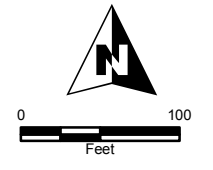

Revised: 7/28/2017

By: MBG



PINAL COUNTY  
wide open opportunity

Pinal County Assessor

THIS MAP DOES NOT REPRESENT A SURVEY. NO LIABILITY IS ASSUMED FOR THE ACCURACY OF THE DATA DELINEATED HEREIN, EITHER EXPRESSED OR IMPLIED BY PINAL COUNTY OR ITS EMPLOYEES. THIS MAP IS COMPILED FROM OFFICIAL RECORDS, INCLUDING PLATS, SURVEYS, RECORDED DEEDS AND CONTRACTS, AND ONLY CONTAINS INFORMATION REQUIRED FOR THE PINAL COUNTY ASSESSOR'S OFFICE PURPOSES.