

SEE MAP 210-25

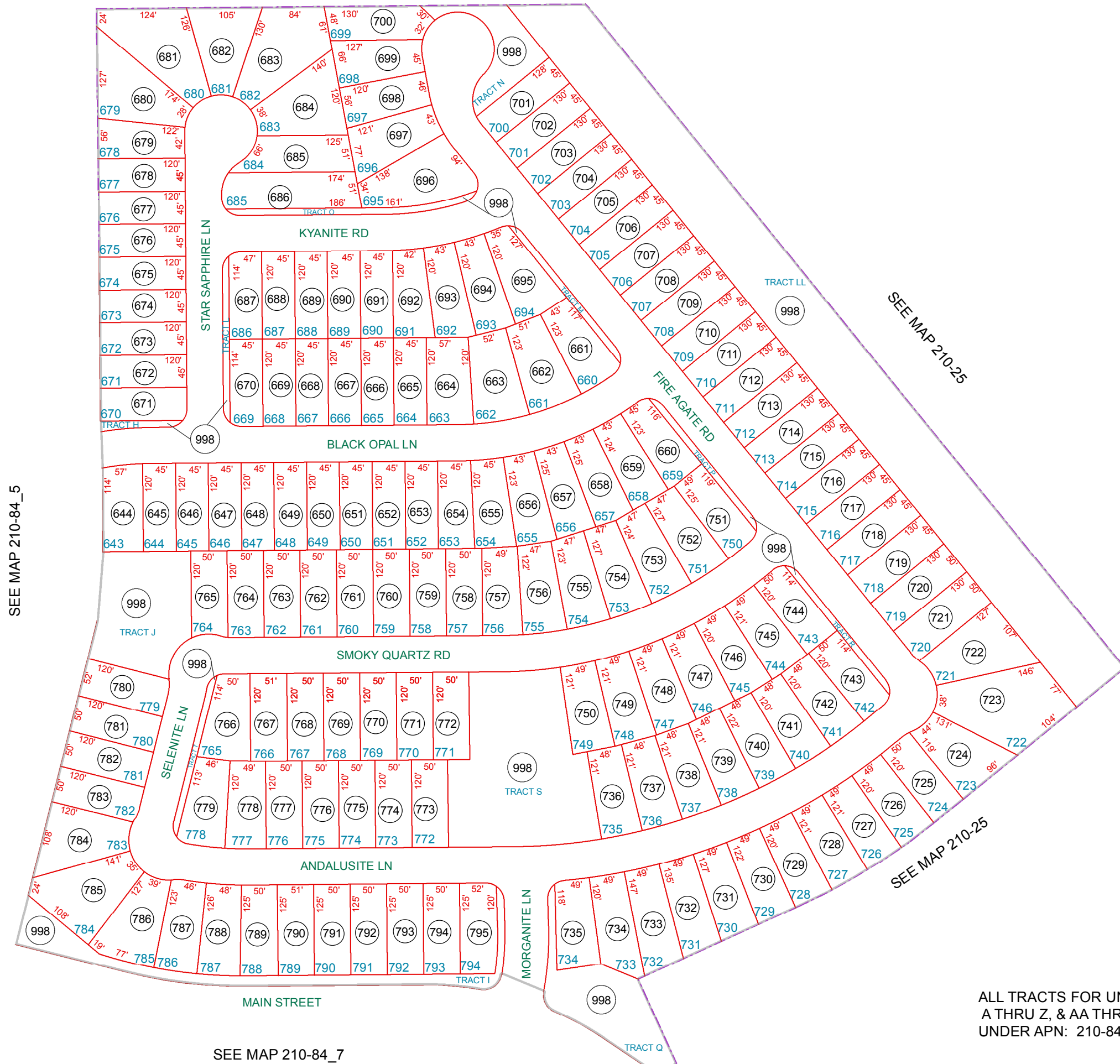

ALL TRACTS FOR UNIT 5B
 A THRU Z, & AA THRU LL
 UNDER APN: 210-84-998

SEE MAP 210-84_5

SEE MAP 210-84_7

BOOK - MAP
210-84_6

SEC. 27 T.03S. R.08E.
 THE VILLAGE AT COPPER BASIN
 UNIT 5B
 2013-074919

LOCATION MAPS

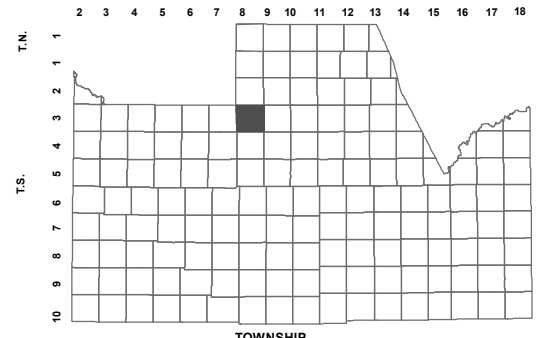

HASH KNIFE DRAW RD		SCHNEPF RD			
6	5	4	3	2	1
SKYLINE DR		GARDNER RD		SIERRA VISTA RD	
7	8	9	10	11	12
ROBERTS RD		BELLA VISTA RD		QUAIL RUN LN	
18	17	16	15	14	13
GARY RD		JUDD RD		ATTAWAY RD	
19	20	21	22	23	24
HUNT RD		MAGMA RD		ARIZONA FARMS RD	
30	29	28	27	26	25
31	32	33	34	35	36
SECTION					

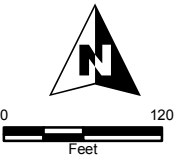

Revised: 12/23/2013
 By: DW



PINAL COUNTY
wide open opportunity
Pinal County Assessor

THIS MAP DOES NOT REPRESENT A SURVEY. NO LIABILITY IS ASSUMED FOR THE ACCURACY OF THE DATA DELINEATED HEREIN, EITHER EXPRESSED OR IMPLIED BY PINAL COUNTY OR ITS EMPLOYEES. THIS MAP IS COMPILED FROM OFFICIAL RECORDS, INCLUDING PLATS, SURVEYS, RECORDED DEEDS AND CONTRACTS, AND ONLY CONTAINS INFORMATION REQUIRED FOR THE PINAL COUNTY ASSESSOR'S OFFICE PURPOSES.