

SEC. 11 NE TN.5S RG.4E

SEE MAP 502-06

502-45
1/2

SADDLEBACK FARMS
UNIT 2 AMENDED

BK. 18 - PG. 31

THE ORIGINAL PLAT OF THIS SUBDIVISION IS
ON FILE WITH THE PINAL COUNTY RECORDERS
OFFICE, FOR COMPLETE INFORMATION OF PLAT
AND CC&R's CALL (520) 868-7100.

AREA CODE
0000

SPECIAL DISTRICTS
00000
00000

THIS MAP IS FOR TAX PURPOSES ONLY.
THIS OFFICE WILL NOT ASSUME LIABILITY FOR
REPRESENTATION, MEASUREMENTS OR ACREAGE.

SEE MAP 502-09

VICINITY MAP

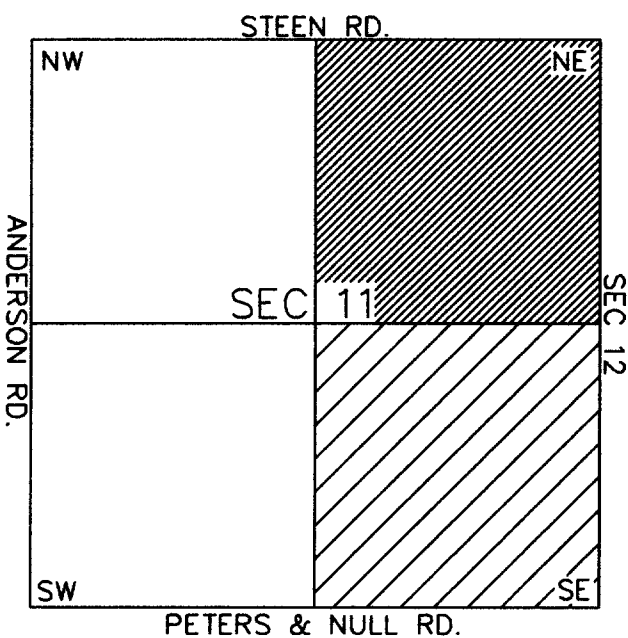

Exc! 612'		Exc! 612'		Exc! 612'		Exc! 612'	
86	(22)	235'	87	(23)	235'	130	(66)
85	(21)		88	(24)		129	(65)
84	(20)		89	(25)		128	(64)
83	(19)		90	(26)		127	(63)
82	(18)		91	(27)		126	(62)
81	(17)		92	(28)		125	(61)
80	(15) A		93	(29)		124	(60)
79			94	(30)		123	(59)
78	(14)		95	(31)		122	(58)
77	(13)	235'	96	(32)	235'	121	(57)
76	(12)	236'	97	(33)	236'	120	(56)
	587'			587'			587'

SEE MAP 502-45_2

SEE MAP 502-06



SCALE: 1" = 300'

04-24-2002