

SEC. 29 SESE TN.6S RG.5E

SEE MAP 503-52

503-66

THIS MAP IS FOR TAX PURPOSES ONLY.
THIS OFFICE WILL NOT ASSUME LIABILITY FOR
REPRESENTATION, MEASUREMENTS OR ACREAGE.

THE ORIGINAL PLAT OF THIS SUBDIVISION IS
ON FILE WITH THE PINAL COUNTY RECORDERS
OFFICE, FOR COMPLETE INFORMATION OF PLAT
AND CC&R's CALL (520) 868-7100.

CASA GRANDE WEST
UNIT 4

BK 14 - PG 005

SEE MAP 503-65

GUINN DR.

CARMEL BLVD.

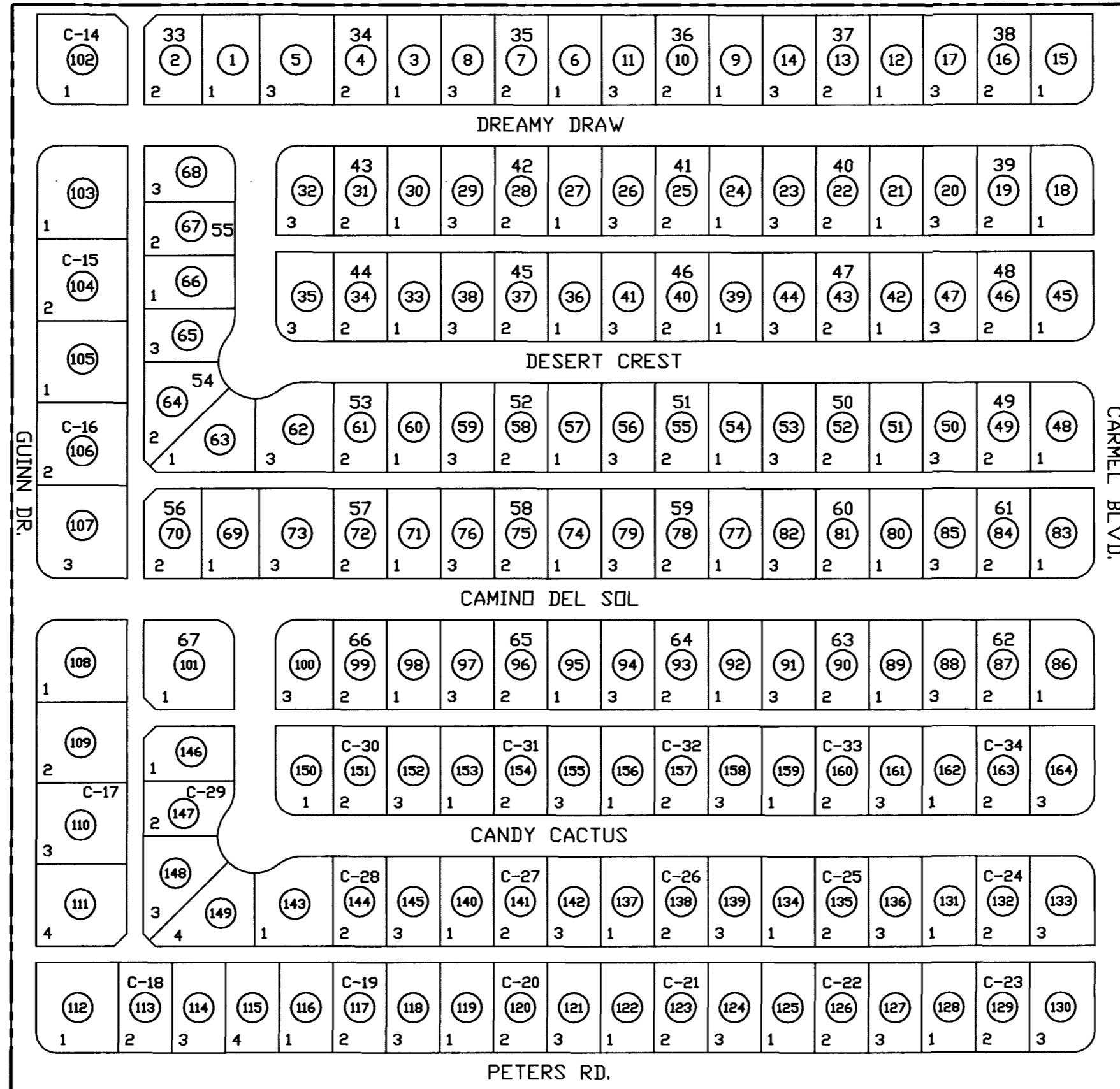

VICINITY MAP

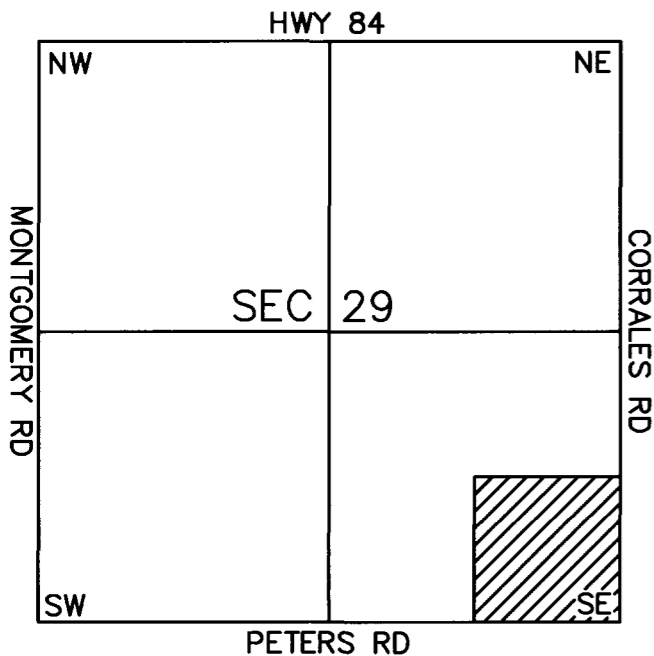

SCALE: 1" = 150'

05-24-2003

SEE MAP 503-54

PINAL COUNTY ASSESSORS MAP