

SEC. 21 NE TN.6S RG.5E

SEE MAP 503-61

503-68

1/4

DESERT CARMEL

UNIT G

BK 14 - PG 018

AREA CODE
0000

SPECIAL DISTRICTS
00000
00000

THIS MAP IS FOR TAX PURPOSES ONLY.
THIS OFFICE WILL NOT ASSUME LIABILITY FOR
REPRESENTATION, MEASUREMENTS OR ACREAGE.

THE ORIGINAL PLAT OF THIS SUBDIVISION IS
ON FILE WITH THE PINAL COUNTY RECORDERS
OFFICE, FOR COMPLETE INFORMATION OF PLAT
AND CC&R'S CALL (520) 868-7100.

SEE MAP 503-68_2

VICINITY MAP

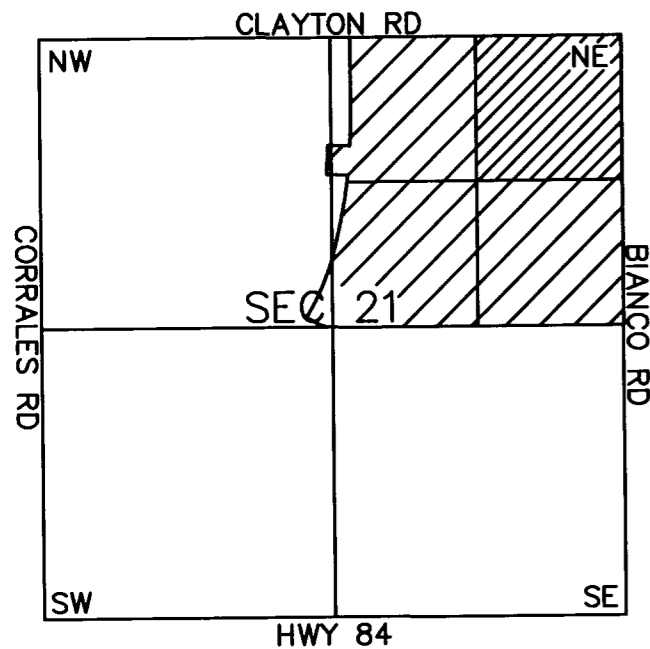

542	541	508	507	474	473	440	439	406	405
543	540	509	506	475	472	441	438	407	404
544	539	510	505	476	471	442	437	408	403
545	538	511	504	477	470	443	436	409	402
546	537	512	503	478	469	444	435	410	401
547	536	513	502	479	468	445	434	411	400
548	535	514	501	480	467	446	433	412	399
549	534	515	500	481	466	447	432	413	398
550	533	516	499	482	465	448	431	414	397
551	532	517	498	483	464	449	430	415	396
552	531	518	497	484	463	450	429	416	395
553	530	519	496	485	462	451	428	417	394
554	529	520	495	486	461	452	427	418	393
555	528	521	494	487	460	453	426	419	392
556	527	522	493	488	459	454	425	420	391
557	526	523	492	489	458	455	424	421	390
558	525	524	491	490	457	456	423	422	389

368	369	370	371	372	373	374	375	376	377	378	379	380	381	382	383	384	385	386	387	388
-----	-----	-----	-----	-----	-----	-----	-----	-----	-----	-----	-----	-----	-----	-----	-----	-----	-----	-----	-----	-----

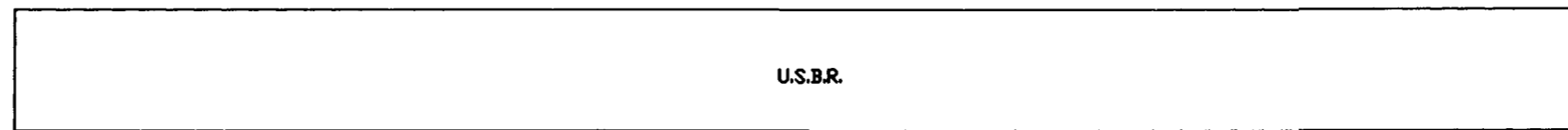

SEE MAP 503-68_4

SEE MAP 503-44



SCALE: 1" = 150'

05-24-2003