

# SEC. 22 TN.06S RG.06E

# 505-73

## WILDFLOWER UNIT 3 (AMENDED)

### CAB "C" SLIDE 086

AREA CODE  
0484

SPECIAL DISTRICTS  
00000  
00000

SEE MAP 505-75

THIS MAP IS FOR TAX PURPOSES ONLY.  
THIS OFFICE WILL NOT ASSUME LIABILITY FOR  
REPRESENTATION, MEASUREMENTS OR ACREAGE.

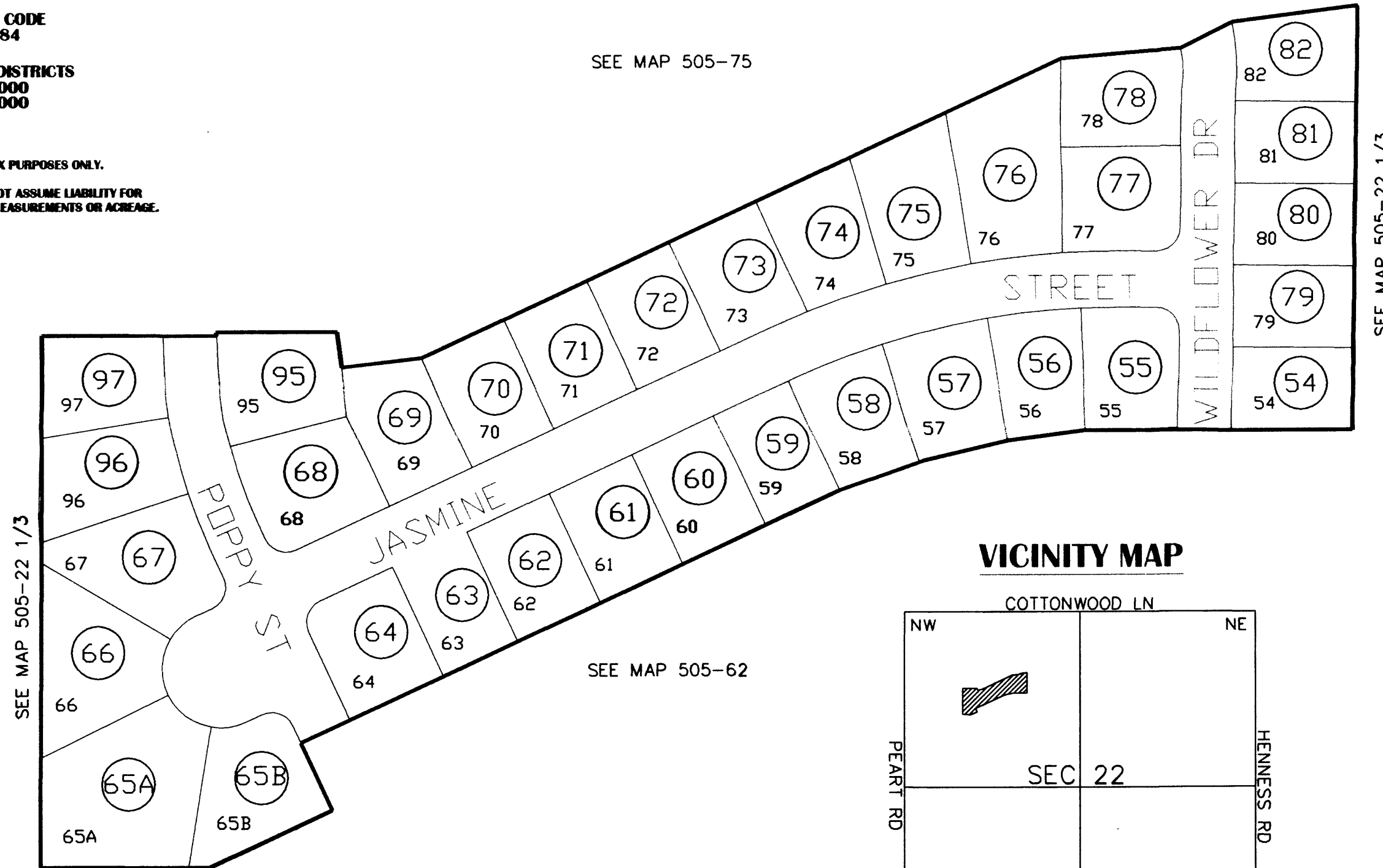

SEE MAP 505-22 1/3

THE ORIGINAL PLAT OF THIS SUBDIVISION IS  
ON FILE WITH THE PINAL COUNTY RECORDERS  
OFFICE, FOR COMPLETE INFORMATION OF PLAT  
AND C&R's CALL (520) 868-7100.

### VICINITY MAP

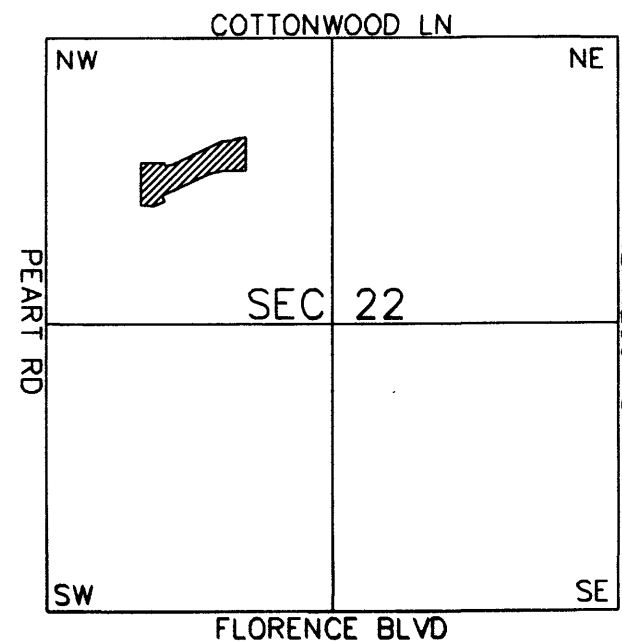

SCALE: 1" = 100'

1-25-2002