

SEE MAP 505-22  
 FLORENCE BLVD / HWY 287

SEE MAP 505-28  
 NOBLE ST

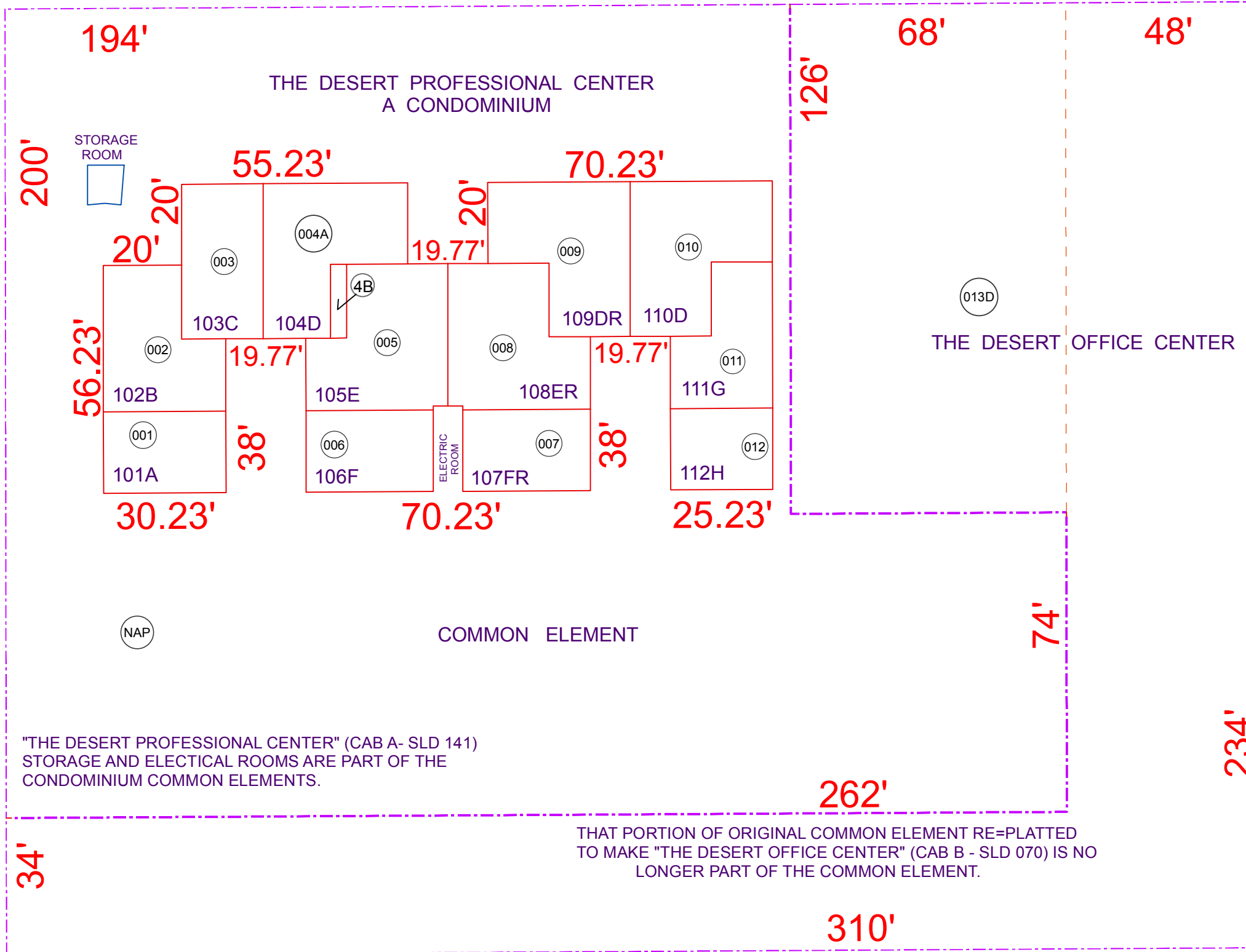

"THE DESERT PROFESSIONAL CENTER" (CAB A- SLD 141)  
 STORAGE AND ELECTRICAL ROOMS ARE PART OF THE  
 CONDOMINIUM COMMON ELEMENTS.

THAT PORTION OF ORIGINAL COMMON ELEMENT RE=PLATTED  
 TO MAKE "THE DESERT OFFICE CENTER" (CAB B - SLD 070) IS NO  
 LONGER PART OF THE COMMON ELEMENT.

SEE MAP 505-28

BOOK - MAP

# 505-51

NW NW SEC. 27 T.06S. R.06E.

THE DESERT PROFESSIONAL CENTER  
 A CONDOMINIUM

CAB A - SLD 141

THE DESERT OFFICE CENTER

CAB B - SLD 070

LOCATION MAPS  
 R.E.

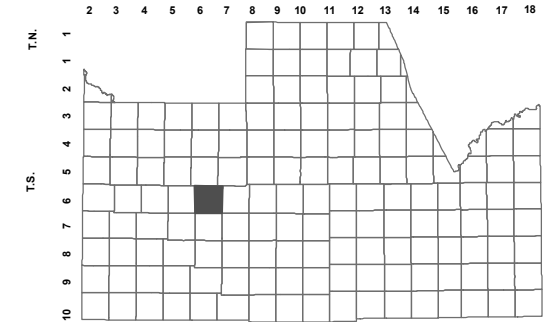

TOWNSHIP McCARTNEY RD					
6	5	4	3 RODEO RD	2	1
7	8	9	10 N HENNESSY RD	11 KORTSEN RD	12
18	17	16	15 N HENNESSY RD	14 STOREY RD	13
19	20	21	22 FLORENCE BLVD / HWY 287	23	24
30	29	28	27	26 N COX RD	25
31	32	33	34	35 N COX RD	36

SECTION SELMA HWY



Revised: 10/31/2014

By: **TH**



PINAL COUNTY  
*wide open opportunity*

Pinal County Assessor

THIS MAP DOES NOT REPRESENT A SURVEY. NO LIABILITY IS ASSUMED FOR  
 THE ACCURACY OF THE DATA DELINEATED HEREIN, EITHER EXPRESSED OR  
 IMPLIED BY PINAL COUNTY OR ITS EMPLOYEES. THIS MAP IS COMPILED FROM  
 OFFICIAL RECORDS, INCLUDING PLATS, SURVEYS, RECORDED DEEDS AND  
 CONTRACTS, AND ONLY CONTAINS INFORMATION REQUIRED FOR THE PINAL  
 COUNTY ASSESSOR'S OFFICE PURPOSES.