

COMMON AREA 512-48-960
INCLUDES:
 TRACTS A18 THRU H18
 OF 2018-027718
COMMON AREA 512-48-568
INCLUDES:
 TRACT D18 OF CAB G - SLD 127

SEE MAP 512-48_7

RE-PLAT OF PARCEL 18 AT HOMESTEAD NORTH

SEE MAP 512-43_1

CONTINENTAL BLVD

WILFORD AVE

NAP

SCOLA ST

GRANTHAM RD

WHITE & PARKER RD

SEE MAP 502-03_1

SEE MAP 510-71_1 HONEYCUTT RD

TRACT D18
 CAB G - SLD 127

BOOK - MAP

512-48_6

SE SE SEC. 24 T.04S. R.03E.
PARCEL 18 AT HOMESTEAD NORTH
CAB G - SLD 127

RE-PLAT OF PARCEL 18 AT
HOMESTEAD NORTH
2018-027718

LOCATION MAPS
 R.E.

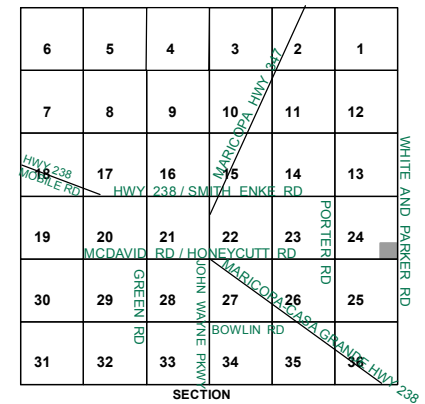
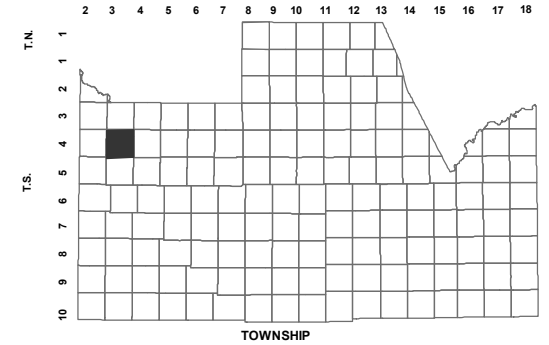

Revised: 8/24/2018

By: **MBG**



PINAL COUNTY

WIDE OPEN OPPORTUNITY

Pinal County Assessor

THIS MAP DOES NOT REPRESENT A SURVEY. NO LIABILITY IS ASSUMED FOR THE ACCURACY OF THE DATA DELINEATED HEREIN, EITHER EXPRESSED OR IMPLIED BY PINAL COUNTY OR ITS EMPLOYEES. THIS MAP IS COMPILED FROM OFFICIAL RECORDS, INCLUDING PLATS, SURVEYS, RECORDED DEEDS AND CONTRACTS, AND ONLY CONTAINS INFORMATION REQUIRED FOR THE PINAL COUNTY ASSESSOR'S OFFICE PURPOSES.